

# To Activate Your WTAMU Student Technology Account

1. Open an internet browser such as Firefox, Internet Explorer or Chrome.
2. In the address bar of your browser, type [www.wtamu.edu/activate](http://www.wtamu.edu/activate)

The screenshot shows the 'Verification' page of the Password Self Service. It features a captcha with the text 'over EFFrie'. A text input field contains 'Over EFFrie'. Below the input field are three buttons: 'Verify', 'Clear', and 'Cancel'. A blue callout box with a green circle containing the number '1' points to the captcha and contains the text 'Enter the Captcha code just like you see it on your screen.' A second blue callout box with a green circle containing the number '2' points to the 'Verify' button and contains the text 'Click Verify after you enter the Captcha Code.'

3. Enter the **Captcha Code** and click **Verify**
4. Enter your information:
  - Enter your **7 digit WTAMU ID (Gold Card)** number (you might have to add a leading zero (0) – this is a zero (or zeros) in front of the actual numbers on your ID to make it 7 digits.
  - Enter your **last name**
  - Enter your **birthday** (YYYY-MM-DD)
5. Click **Activate**

The screenshot shows the 'Activate Account' page of the Password Self Service. It contains a form with three input fields: 'WT ID Number [7 digits, including leading zero(s)] (e.g. "0123456")', 'Last Name', and 'Birth date (YYYY-MM-DD) (e.g. "1910-09-20")'. Below the form are three buttons: 'Activate', 'Clear', and 'Cancel'. A blue callout box with a green circle containing the number '4' points to the form fields and contains the text '--Enter your Gold Card #', '--Last Name', and '--Birth Date'. A second blue callout box with a green circle containing the number '5' points to the 'Activate' button and contains the text 'Click Activate.'

6. Check **I Agree**
7. Click **Continue**.

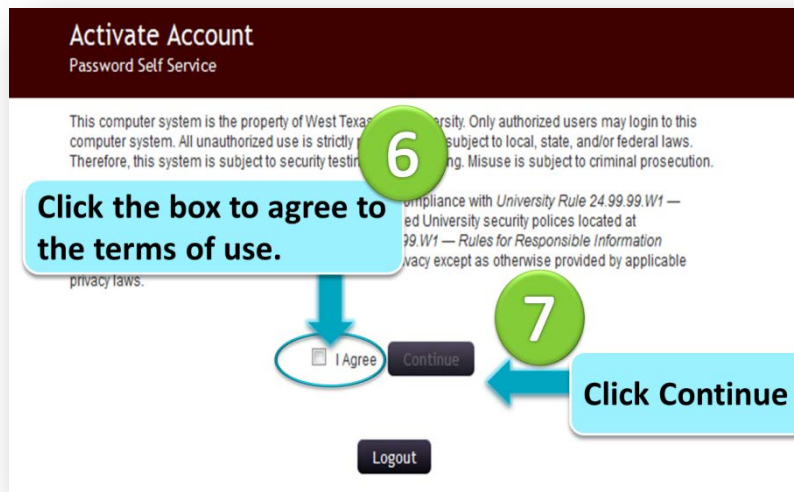

8. Read about how to determine your username, click **Continue**.
9. **Enter and Confirm** your new password
10. Click **Create Password**.

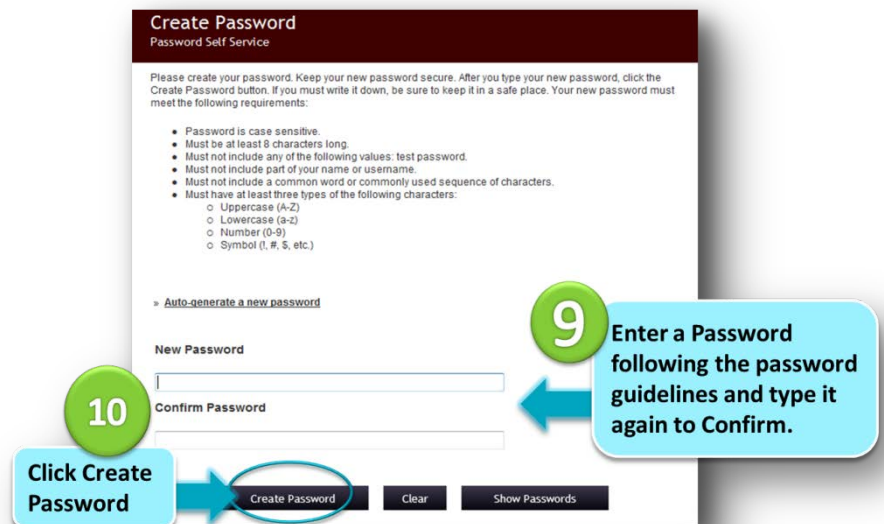

11. Click **Continue** to continue to the login page of MyBuffPortal.

