

EMAIL SETUP ON IOS MOBILE DEVICE

If you are not able to login please contact the IT Success Center and specify that you are needing assistance with logging in to your email on a device.

1. Enter **Settings** and navigate to **Mail, Contacts, Calendars**
2. Choose **Add account**, and select **Exchange**

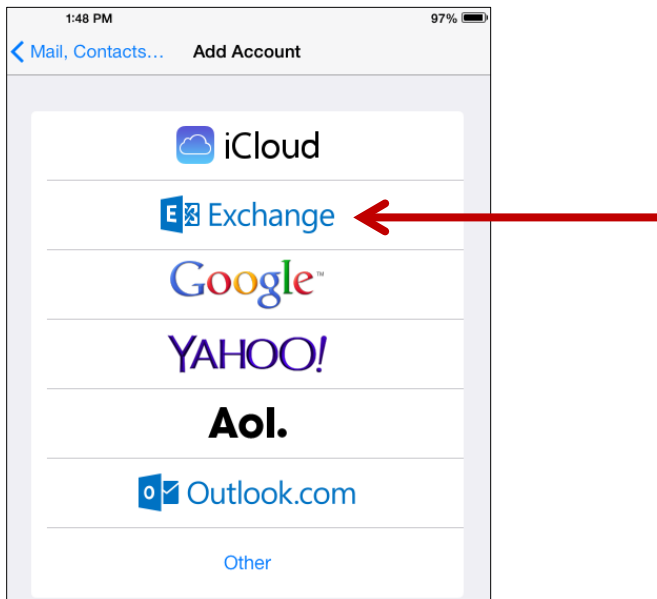

3. Enter your **email address**, **password**, and **description**. Click **Next**.

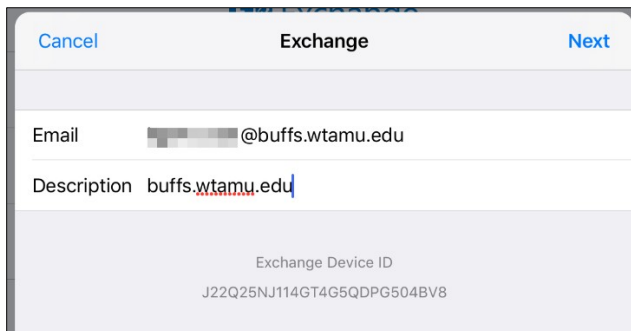

4. Select **Configure Manually**

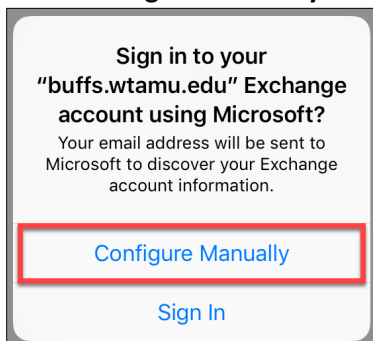

5. Enter your password

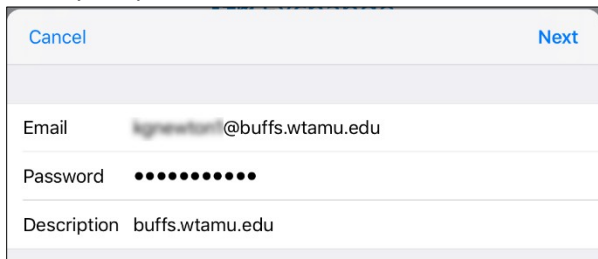

A screenshot of an email setup screen. At the top left is a blue "Cancel" button and at the top right is a blue "Next" button. Below these are three input fields: "Email" containing a redacted address followed by "@buffs.wtamu.edu", "Password" containing ten black dots, and "Description" containing "buffs.wtamu.edu".

6. Click **Next**

7. In the server box type **m.outlook.com** and type **your email** into the username box

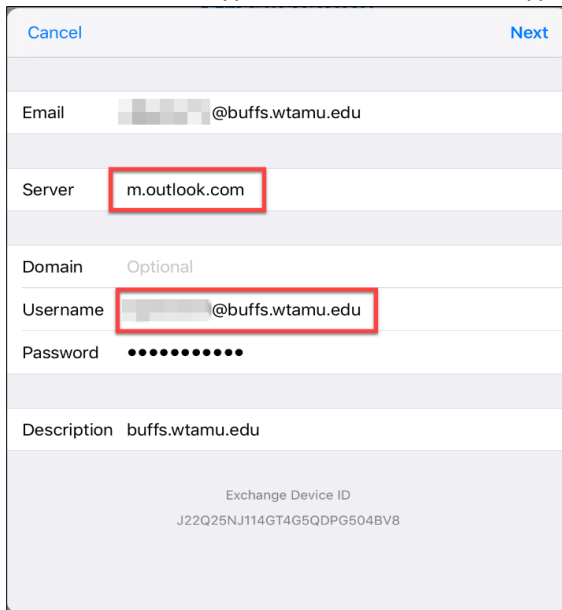

A screenshot of an email setup screen. At the top left is a blue "Cancel" button and at the top right is a blue "Next" button. Below these are several input fields: "Email" with a redacted address followed by "@buffs.wtamu.edu", "Server" with "m.outlook.com" (highlighted by a red box), "Domain" with "Optional", "Username" with a redacted address followed by "@buffs.wtamu.edu" (highlighted by a red box), "Password" with ten black dots, and "Description" with "buffs.wtamu.edu". At the bottom, there is an "Exchange Device ID" field containing the text "J22Q25NJ114GT4G5QDPG504BV8".

8. Click **Next**